

DECK & SUITE PLANS SILVER SHADOW | SILVER WHISPER

ALL SUITES FEATURE: Separate sitting area, walk-in closet(s) with personal safe, writing desk, personalized stationery and direct dial telephones, dressing table with hair dryer, refrigerator stocked with your preference of beverages. The Grand, Royal, Owner's and Silver Suites feature dining area and living area(s).



**THE GRAND SUITE** 1,286-1,435 SQUARE FEET

- Two teak verandas with patio furniture and floor-to-ceiling glass doors
- Queen-sized bed(s)
- CD player, one flat-screen plasma television and two remote-controlled televisions with VCRs, all with satellite reception
- Two marbled bathrooms with double vanity, separate shower (one with full-sized Jacuzzi tub and water closet with bidet) plus a powder room

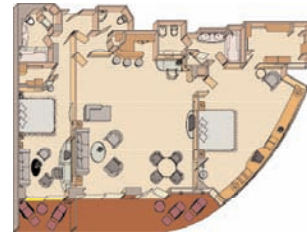

Available as a two-bedroom (as shown) or a one-bedroom configuration.



**THE ROYAL SUITE** 1,312-1,352 SQUARE FEET

- Two teak verandas with patio furniture and floor-to-ceiling glass doors
- Queen-sized bed(s)
- CD player, one flat-screen plasma television and two remote-controlled televisions with VCRs, all with satellite reception
- Two marbled bathrooms with double vanity, separate shower (one with full-sized Jacuzzi tub and water closet with bidet) plus a powder room



Available as a two-bedroom (as shown) or a one-bedroom configuration.



**THE OWNER'S SUITE** 1,208 SQUARE FEET

- 200-square foot teak veranda with patio furniture and floor-to-ceiling glass doors
- Twin beds or queen-sized bed(s)
- CD player, one flat-screen plasma television and two remote-controlled televisions with VCRs, all with satellite reception
- Two marbled bathrooms with double vanity, separate shower (one with full-sized Jacuzzi tub and water closet with bidet) plus a powder room

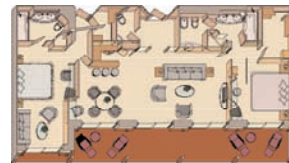

Available as a two-bedroom (as shown) or one-bedroom configuration.



**THE SILVER SUITE** 701 SQUARE FEET

- Teak veranda with patio furniture and floor-to-ceiling glass doors
- Living room (with convertible sofa to accommodate an additional guest)
- Twin beds or queen-sized bed
- CD player, two remote-controlled televisions with VCRs and satellite reception
- Marbled bathroom with double vanity
- Full-sized bathtub, separate shower and water closet



Not shown: Medallion Suite — offering similar floorplan as Silver Suite; 521 SQUARE FEET  
Please ask your travel professional for details



**THE VERANDA + MIDSHIP VERANDA SUITE** 345 SQUARE FEET

- Teak veranda with patio furniture and floor-to-ceiling glass doors
- Twin beds or queen-sized bed
- Remote-controlled television with VCR and satellite reception
- Marbled bathroom with double vanity
- Full-sized bathtub and separate shower



Some Veranda Suites accommodate three guests.  
The Midship Veranda Suite offers preferred midship location with identical accommodations to a Veranda Suite



**THE VISTA SUITE** 287 SQUARE FEET

- Large picture window providing panoramic ocean views
- Twin beds or queen-sized bed
- Remote-controlled television with VCR and satellite reception
- Marbled bathroom with double vanity
- Full-sized bathtub and separate shower



Some Vista Suites accommodate three guests.

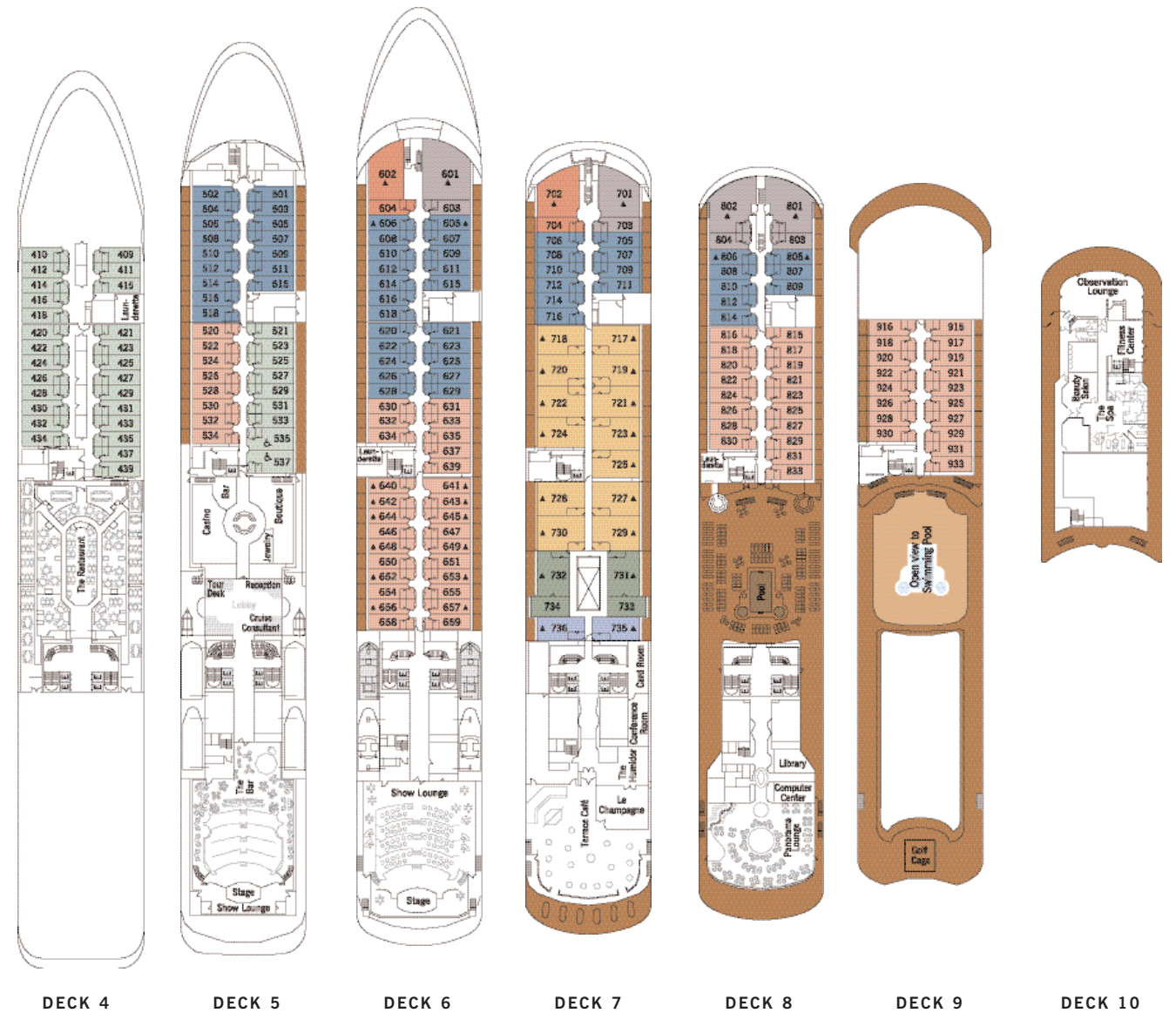
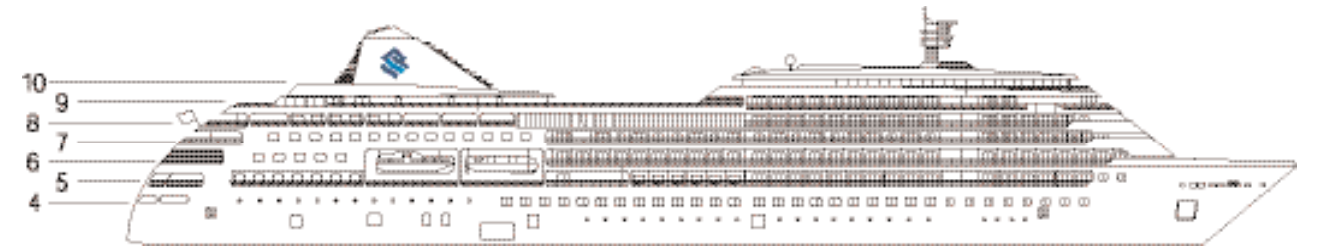

SPECIFICATIONS

BUILT: 2000/2001  
REGISTRY: Bahamas  
CREW: 295  
OFFICERS: Italian  
GUESTS: 382  
TONNAGE: 28,258  
LENGTH: 610 Feet  
WIDTH: 81.8 Feet

SPEED: 21 Knots  
PASSENGER DECKS: 7  
3RD GUEST CAPACITY  
HANDICAP SUITES (535 and 537)  
VISTA SUITES 521, 523, 525, 527, 529, 531, 533, 535 and 537 share a common veranda.

GRAND SUITE  
ROYAL SUITE  
OWNER'S SUITE  
SILVER SUITE  
MEDALLION SUITE  
MIDSHIP VERANDA  
VERANDA SUITE  
VISTA SUITE

▲  
♿

**NOTE:** Suites 416/418, 511/515, 516/518 and 616/618 are connecting suites.