

'Le Lyrial' Deck Plan

- Category 1
Classic Stateroom
- Category 2
Deluxe Stateroom
- Category 3
Premier Stateroom
- Category 4
Prestige Suite
- Category 5
Premier Two-Room Suite
- Category 6
Privilege Two-Room Suite
- Category 7
Grand Deluxe Two-Room Suite
- Category 8
Grand Privilege Three-Room Suite
- Category 9
Owner's Suite

BUTLER SERVICE INCLUDED

Premier Two-Room Suite may be converted to two Premier Staterooms

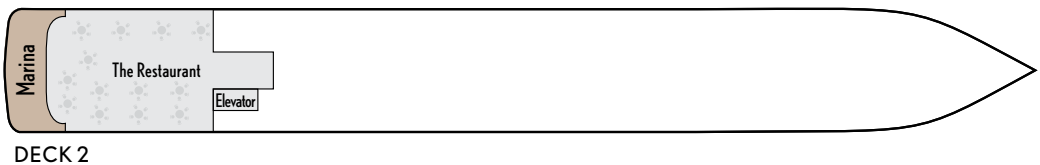
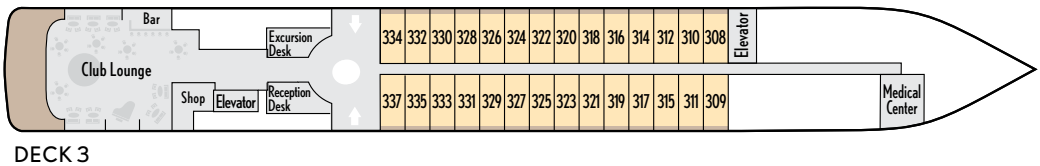
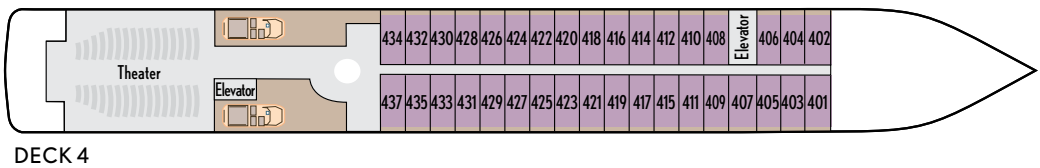
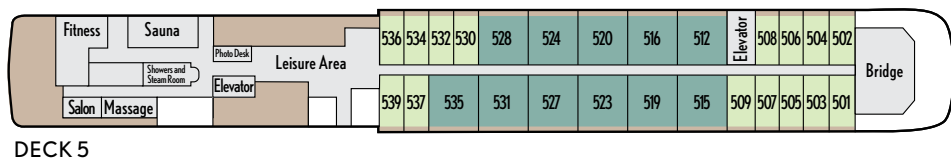
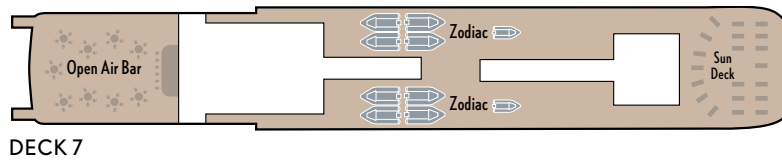

Exclusive Amenities for A&K Chartered Voyages

- ▶ A guest capacity limited to 199 total travellers (from a maximum of 244)
- ▶ A&K's expert Expedition Team, average of 20 members, on board every journey
- ▶ One of the most intimate personnel-to-guest ratios at sea of 1 to 1.3
- ▶ All English-speaking ship staff (customary onboard language is French)
- ▶ Private balcony with every guest stateroom and suite
- ▶ Complimentary butler service with every suite: includes welcome Champagne, nightly canapés, packing/unpacking on request and more
- ▶ A&K's complimentary Traveller's Valet laundry service
- ▶ Complimentary wireless Internet (due to remote destinations, access and speed vary)

'Le Lyrial' Cabin Layouts

BUTLER SERVICE INCLUDED

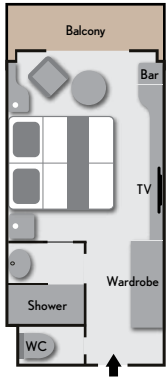

Categories 1-3
Staterooms

Cabin: 200 sq. ft. (18 sq. m.)
Balcony: 43 sq. ft. (4 sq. m.)



Category 4
Prestige Suite

Cabin: 291 sq. ft. (27 sq. m.)
Balcony: 65 sq. ft. (6 sq. m.)

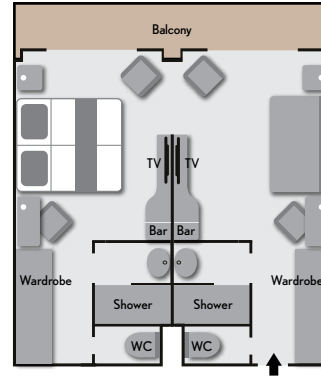

Category 5
Premier Two-Room Suite

Cabin: 388 sq. ft. (36 sq. m.)
Balcony: 86 sq. ft. (8 sq. m.)

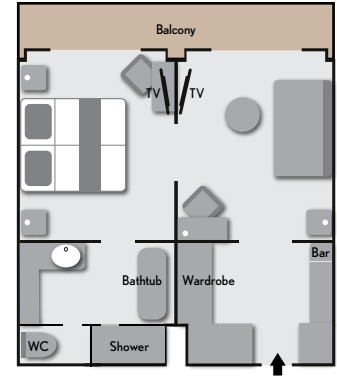

Category 6
Privilege Two-Room Suite

Cabin: 388 sq. ft. (36 sq. m.)
Balcony: 86 sq. ft. (8 sq. m.)

BUTLER SERVICE INCLUDED

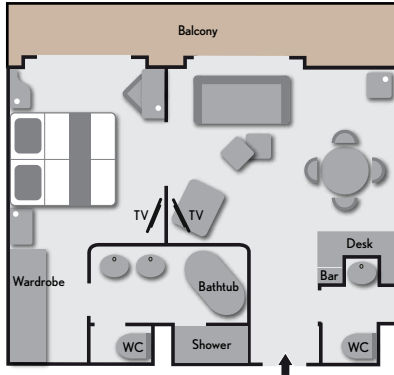

Category 7
Grand Deluxe Two-Room Suite

Cabin: 484 sq. ft. (45 sq. m.)
Balcony: 108 sq. ft. (10 sq. m.)

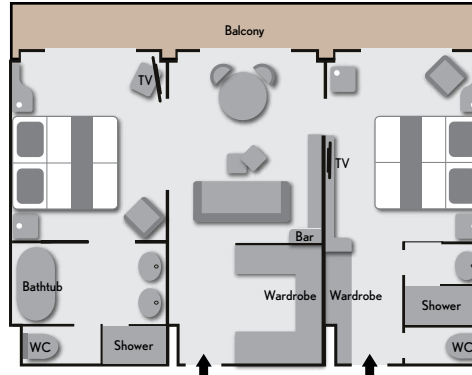

Category 8
Grand Privilege Three-Room Suite

Cabin: 581 sq. ft. (54 sq. m.)
Balcony: 129 sq. ft. (12 sq. m.)

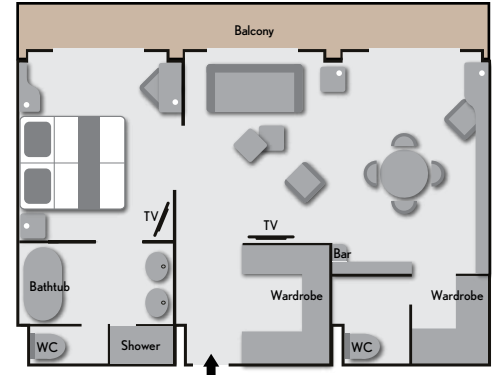

Category 9
Owner's Suite

Cabin: 581 sq. ft. (54 sq. m.)
Balcony: 129 sq. ft. (12 sq. m.)

Amenities

- ▶ Stateroom and suite amenities include a hair dryer, large wardrobe and ample storage, safe, alarm clock, and luxury bath products
- ▶ Stateroom electricity: 220V outlets — Europe two-prong style (plus two 110/220 U.S. outlets)
- ▶ Sun Deck and multiple outer deck observation areas
- ▶ Outside heated pool
- ▶ Library with selection of books and games
- ▶ Two restaurants: Main and indoor/outdoor Grill
- ▶ Open bar with beer, wine, liquor, cocktails, soft drinks, coffee, tea and mineral water (excludes premium wines and spirits)
- ▶ Two lounges with bars: Club with live music and Panoramic with Terrace
- ▶ Complimentary 24-hour room service
- ▶ Complimentary in-cabin breakfast (on request)
- ▶ Three passenger elevators
- ▶ Panoramic Fitness Center with Kinesis® wall
- ▶ Full-service spa with spa, massage rooms, sauna and steam room
- ▶ Theater with comfortable seating for all guests
- ▶ Boutique
- ▶ 24-hour medical facilities with certified doctor and nurse

'Le Lyrial' Gallery

Stateroom and Suites



Stateroom



Privilege Two-Room Suite



Grand Deluxe Two-Room Suite



Grand Privilege Three-Room Suite



Owners Suite

Common Areas



Theater



Club Lounge



Panoramic Lounge



Main Restaurant

Ship Details

- ▶ Launched in 2015
- ▶ Overall length: 466 feet
- ▶ Beam: 59 feet
- ▶ Draft: 15.3 feet
- ▶ Average speed: 12 knots
- ▶ Ice class: 1C
- ▶ Passenger decks: 6
- ▶ Gross tonnage: 10,944 UMS
- ▶ Electric Motors: 2 x 2,300 KW
- ▶ Standards: USPHS – U.S. Coast Guard's Rules Comfort Class 1 Clean-Ship Certification (meets or exceeds all IMO, EPA, IAATO and AECO operating standards)
- ▶ Technology: Advanced dynamic positioning system and highly efficient stabilizers
- ▶ Flag: French